

- Meets National Codes For Structural Integrity
- Price Stable Year Round
- Breathable
- Earth Friendly
- Installs Easily

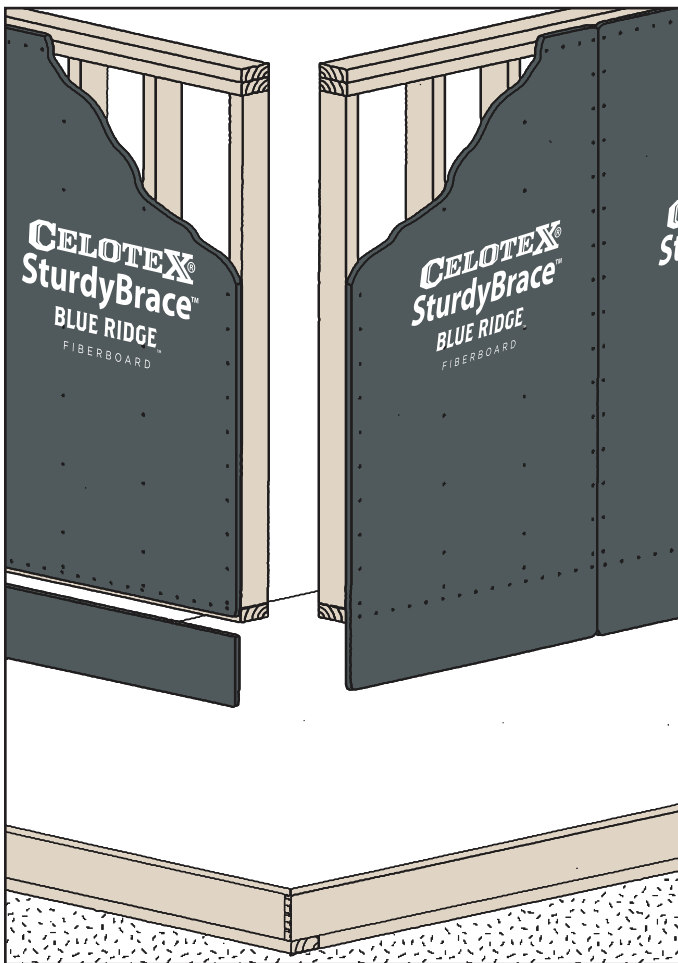

Application

Fastening Pattern Requirement — Structural Application

Attach to wood studs using 1-1/2" 16 gauge corrosion-resistant staples with a minimum 7/16" crown.

Recommended fastening pattern is 2" on-center along the perimeter and 6" on-center in the field of each panel.

The Smart and Safe Choice in Structural Sheathing

The insulating exterior wall sheathing is competitively priced. You may bid with confidence year round.

SturdyBrace® improves the structural integrity of homes and light commercial buildings and eliminates the need for corner bracing. SturdyBrace® provides racking strength to meet most wind shear and seismic conditions. Check with code officials in your area.

Trapped moisture in exterior walls is caused by condensation and water leaks. This moisture can lead to mold growth and other water related problems. SturdyBrace® "breathes" permitting the moisture to escape into the outside air.

Mold experts recommend use of wall sheathing with a minimum ASTM permeability rating of 5. SturdyBrace® rates more than 20.0 perms while OSB and plywood have permeability ratings of 2 and less than one respectively.

SturdyBrace® is an earth-friendly fiberboard made of recovered wood fibers interlaced and bonded with asphaltic binders for strength. It is easy to install and cuts with a knife, saving you time and money.

SturdyBrace® is available coated on one or six sides.

SturdyBrace™ saves energy costs at a low cost per R-value. Our wall sheathing provides R-value of 1.3 per 1/2", more than doubling the R-Values of OSB and gypsum sheathing.

**Building codes may require use of weather resistant barrier.*

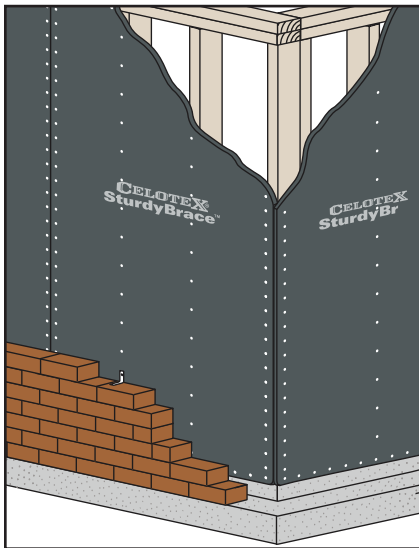

Specifications

Manufactured to conform to ASTM C208, Type IV, Grade 2

For specific installation instructions reference ASTM C846.

Always install SturdyBrace® vertically.

Warning: Check with local building code or an engineer to assure that SturdyBrace® meets the design shear requirements for the structure and area.

Technical information/warnings/ warranty information.

WARNING:

BLUE RIDGE FIBERBOARD PRODUCTS MUST NOT BE USED IN CLOSE PROXIMITY TO CHIMNEYS, HEATER UNITS, FIREPLACES, STEAM PIPES OR OTHER SURFACES WHICH COULD PROVIDE LONG TERM EXPOSURE TO EXCESSIVE HEAT (MAXIMUM 212°F) WITHOUT ADEQUATE THERMAL PROTECTION. CONSULT THE APPROPRIATE HEATING APPLIANCE MANUFACTURER'S INSTRUCTIONS BEFORE INSTALLATION.

STORAGE:

PRIOR TO INSTALLATION, STORE AT A LOCATION WHERE HUMIDITY AND TEMPERATURE DUPLICATES THOSE DURING INSTALLATION AND OCCUPANCY IN ORDER TO STABILIZE THE SHEATHING. STORE IN COVERED UNHEATED AREA PROTECTED FROM THE WEATHER AT ALL TIMES. AFTER APPLICATION OF THE SHEATHING, IT IS RECOMMENDED THAT THE EXTERIOR FINISH BE APPLIED WITHIN 30 DAYS. IF APPLIED SHEATHING SHOULD GET WET, WAIT UNTIL IT IS COMPLETELY DRY BEFORE APPLICATION OF EXTERIOR SIDING.

Characteristics, properties or performance of materials manufactured by BLUE RIDGE herein described are derived from data obtained under controlled test conditions. BLUE RIDGE makes no warranties, express or implied, as to their characteristics, properties, or performance under any variations from such conditions in actual construction. BLUE RIDGE assumes no responsibility for the effects of structural movement.

Limited Warranty

BLUE RIDGE warrants its products and materials against manufacturing defects and defective materials or workmanship for a period of six months from the date such products are shipped from our plant.

Claims

If a claim is made under this warranty it must be in writing, describing the defect in full, and promptly submitted to our address below.

Exclusions from Warranty

1. BLUE RIDGE strives to produce its products to obtain high quality and excellence however, these products are susceptible to imperfections due to the nature of the materials. All final decisions concerning quality and excellence remain exclusively in the discretion of BLUE RIDGE.
2. This warranty does not include problems arising from improper installation and does not cover normal wear and tear, changes in color.
3. If a manufacturing defect does occur, BLUE RIDGE will replace any defective products with new products but will cover only those particular items deemed to be defective. (BLUE RIDGE reserves the right to refund to you the purchase price of any defective item.)

Remedies and Limitations

BLUE RIDGE shall not be obligated or liable for labor or other costs related to dismantlement, installation, repair or replacement of defective products or materials.

Claims under this warranty are limited to replacement of defective products or material.

Implied Warranties

No implied warranties shall extend beyond warranty as stated here.

Incidental or Consequential Damages

BLUE RIDGE disclaims and will not be responsible for any incidental or consequential damages arising from any manufacturing defect in its products.

This Warranty is the only express Warranty provided by BLUE RIDGE. No employee, representative or agent nor any other person has authority to assume or incur on behalf of BLUE RIDGE any obligation or liability in place of or in addition to this Warranty. This Warranty provides specific legal rights, and other rights, which vary from state to state, may be available.

Notice: The information in this document is subject to change without notice. BLUE RIDGE assumes no responsibility for any errors that may inadvertently appear in this document.



Danville Plant

250 Celotex Dr.
Danville, VA 24541
Toll Free: 866.850.8834
Phone: 434.797.1321

Customer Service

Toll Free: 866.850.8834

Technical Support

Toll Free: 800.596.9699

blueridgefiberboard.com